

INNOVATIVE
SOLUTIONS

S **Sprint**
Waste Services

The Sprint Difference

Sprint believes in supplying only the best quality equipment. As such, all Sprint frac tanks boxes are:

- Painted Outside And Underneath With Rust Inhibiting Acrylic Enamel Coat
- New Connecting Catwalk System
- 1/4 Inch Construction
- Steel Shot Blasted
- Most Durable Paint And Lining In The Industry
- Floor Structure Undercoated

FRAC TANKS

Whether they're holding crude oil, chemicals or any other industrial material, frac tanks absolutely have to perform.

- All non-acid fracs come equipped with 10 mil DFT chemical resistant liners.
- Tank pressure / vacuum relief vents are standard (5 psig)
- Level gauging available.
- Available Variants / Options: 500 bbl acid fracs, 200 bbl mini fracs, 500 bbl open top design, round or V-bottom, fixed or removable steam coils, 8" exterior manifold assembly.



HOUSTON • BEAUMONT
CORPUS CHRISTI • BATON ROUGE

PHONE: 281-491-7775
WEB: WWW.SPRINTWASTE.COM



FRAC TANKS



SPECIFICATIONS

Easy Access and Fill

- Drain / Fill: 4" floor drain at rear end, 3" fill pipe to roof at rear, 4" suction line connection at front, 4" mid high connection at front, 8" flanged front manifold connection with turn down to floor sump
- Gel Line: 4" mid high connection on curb side, 4" internal pipe with 3/4" holes located on 12" centers towards floor center, capped on rear end (end near side man-way)
- Manway: 21" manway on front, side, (2) non-sealed hatches on roof
- Pick Up: Standard 5th wheel king pin
- Axle: 25,000 lb. axle with air brakes, 11.00 x 22.5 bias tires on steel disc wheels
- Access: Front stairway

Leak Protection

- Built from new 1/4" Heavy Duty Corrugated Steel
- All welds continuous except substructure crossmembers
- Hydro tested to prevent leakage

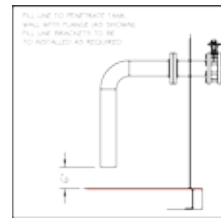
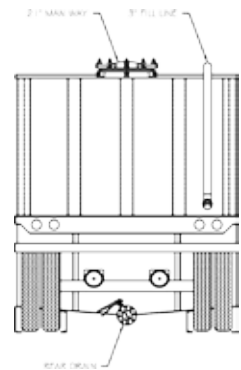
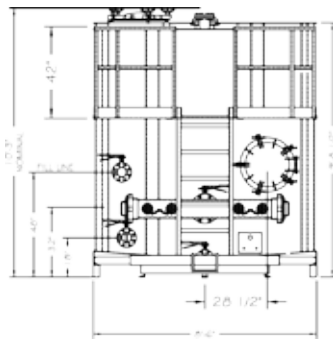

Dimensions Pictured: 45' long, 8'-6" wide, 10' high; 500 barrel capacity

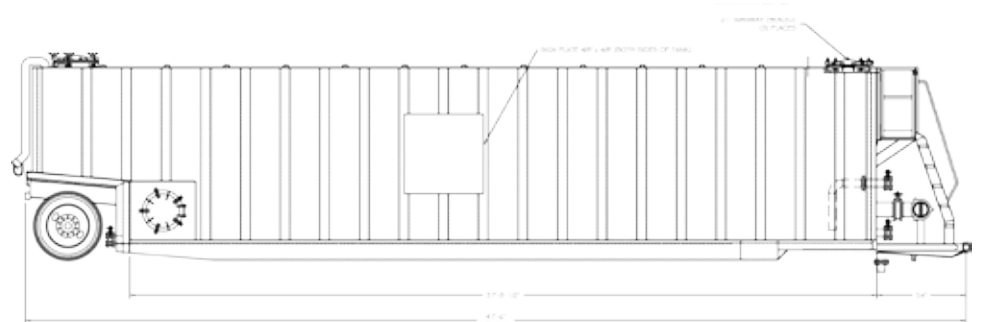

HOUSTON • BEAUMONT
CORPUS CHRISTI • BATON ROUGE

PHONE: 281-491-7775
WEB: WWW.SPRINTWASTE.COM

Size	Weight (lbs)
500 bbl	24,000 - 30,000

 **Sprint
Waste Services**